

Serviced Office Space UK

Reeds Crescent

Watford WD24 4QP

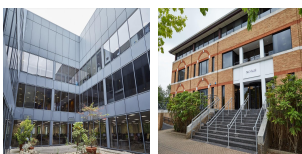
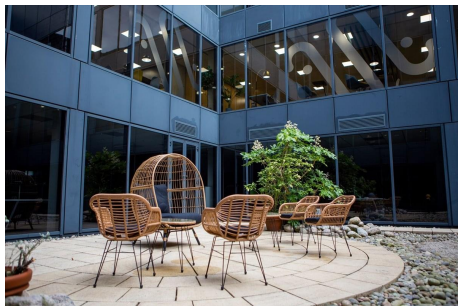

Resting on the edge of Watford town centre, Oak House's attractive location means it sits a five-minute drive from junction 5 of the M1, and 35 minutes from Heathrow Airport and the city of London. The office's enviable transport connections are strengthened with Watford Junction railway station just half a mile away, running a fast and frequent service to London Euston, Birmingham and Clapham Junction. Also within a short walking distance is the Intu Watford Shopping Centre, which offers more than 140 stores, restaurants and leisure facilities. Oak House is a prestigious three-storey office building with excellent parking near Watford Junction Station. Adjoining occupiers include Hilton and JD Wetherspoon. Ideal for an ambitious company ready to upgrade its head office or a larger organisation keen to expand its HQ into a new city.

Nestled on the periphery of Watford town centre, Oak House stands as a prestigious three-storey office building, offering an ideal environment for businesses to prosper and grow. Situated just a brief five-minute stroll from the vibrant heart of Watford's bustling activity, this distinguished edifice boasts a newly refurbished shared reception, along with meticulously designed common areas that foster collaboration and productivity. Additionally, Oak House provides the convenience of a spacious on-site car park, ensuring ease of access for employees and visitors alike. With the added advantage of on-site storage facilities, this remarkable building offers a comprehensive solution to the diverse needs of modern businesses, providing them with the infrastructure and amenities necessary to thrive in today's competitive market landscape.

transport links

Underground	Uxbridge Underground Station
Train Station	Watford Junction London Overground Station
Road Link	N/A
Airport	Heathrow Airport

Leased Spaces

- **Min Size** : 50 sq ft
- **Max Size** : 400 sq ft
- **Total Size** : 23451 sq ft
- **Min Term** : 12 mnths
- **Max Term** : 60 mnths